



Powermax105

Consumables

Mechanized shielded with ohmic 105 A consumables



Mechanized shielded with ohmic 45 A, 65 A, 85 A consumables



Mechanized unshielded 105 A consumables



Mechanized unshielded 45 A, 65 A, 85 A consumables

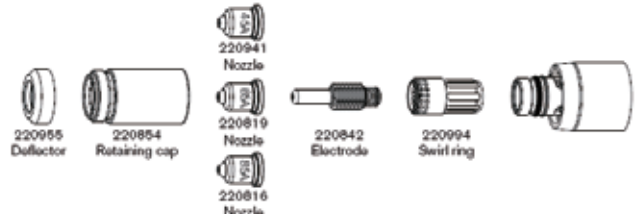

FineCut® shielded consumables



Duramax 180° full-length machine torch replacement parts

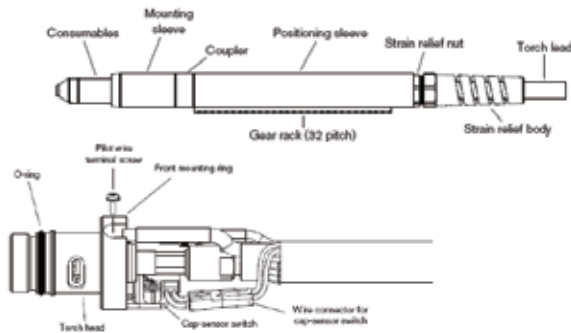

- Mechanized shielded with ohmic 105 A consumables
- Mechanized shielded with ohmic 45 A, 65 A, 85 A consumables
- Mechanized unshielded 105 A consumables
- Mechanized unshielded 45 A, 65 A, 85 A consumables
- FineCut Shielded consumables



Part number	Description
059476*	Powermax65/85/105 180° full-length machine torch assembly with 4.6 m (15 ft) lead
059477*	Powermax65/85/105 180° full-length machine torch assembly with 7.6 m (25 ft) lead
059478*	Powermax65/85/105 180° full-length machine torch assembly with 10.7 m (35 ft) lead
059479*	Powermax65/85/105 180° full-length machine torch assembly with 15.2 m (50 ft) lead
059480*	Powermax65/85/105 180° full-length machine torch assembly with 22.9 m (75 ft) lead
228737	Kit: Powermax65/85/105 180° full-length machine torch/MRT positioning sleeve
228738	Kit: Powermax65/85/105 180° full-length machine torch/MRT removable gear rack replacement
228735	Kit: Powermax65/85/105 180° full-length/mini machine torch/MRT front mounting sleeve
228736	Kit: Powermax65/85/105 180° full-length/mini machine torch/MRT adapter ring (coupler)
228716	Kit: Powermax65/85/105 180° full-length/mini machine torch main body replacement
228720	Kit: Powermax65/85/105 180° full-length/mini machine torch/MRT cap-sensor switch replacement
058519	O-ring
075504	Pilot terminal screw
228730	Kit: Powermax65/85/105 180° full-length/mini machine torch lead replacement, 4.6 m (15 ft)
228731	Kit: Powermax65/85/105 180° full-length/mini machine torch lead replacement, 7.6 m (25 ft)
228732	Kit: Powermax65/85/105 180° full-length/mini machine torch lead replacement, 10.7 m (35 ft)
228733	Kit: Powermax65/85/105 180° full-length/mini machine torch lead replacement, 15.2 m (50 ft)
228734	Kit: Powermax65/85/105 180° full-length/mini machine torch lead replacement, 22.9 m (75 ft)
228314	Kit: Powermax45/65/85/105 torch quick disconnect repair (latch & spring)